

**What's Included**

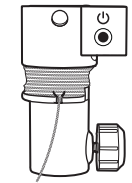

Bulb Changer with 14ft String



Press-Fit Locking Pin



Suction Cup (Recessed Lights)

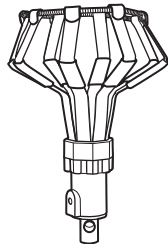

Large Spring-Cage (Flood Lights)



Standard-size Spring-Cage (Incandescent Bulbs)



Standard Bulb Extractor



Candelabra Extractor



Mesh Storage Bag with Drawstring

**Compatibility**

**Standard Spring-Cage for Incandescent Light Bulbs**

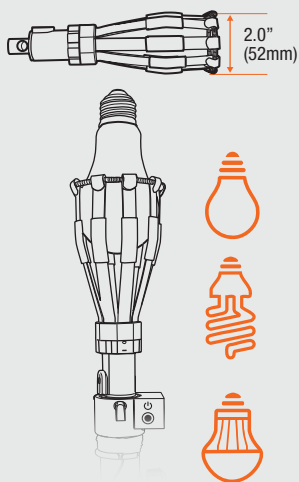

**\*NOTE:** Spring-cage attachments are not recommended for recessed flood light housings, as they may become stuck between the bulb and housing, potentially causing damage. **FOR RECESSED LIGHTING, ALWAYS USE THE PROVIDED SUCTION CUP ATTACHMENT.**

**Large Spring-Cage for Indoor/Outdoor Flood Light\* Bulbs**

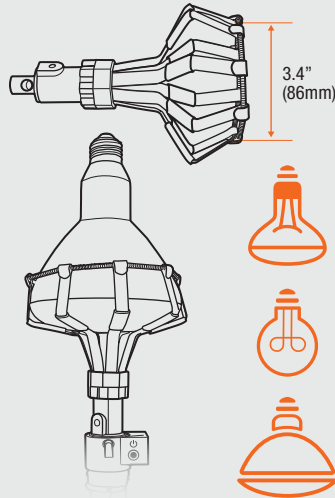

**Suction Cups for Recessed Light Bulbs with Smooth, Flat Surface**

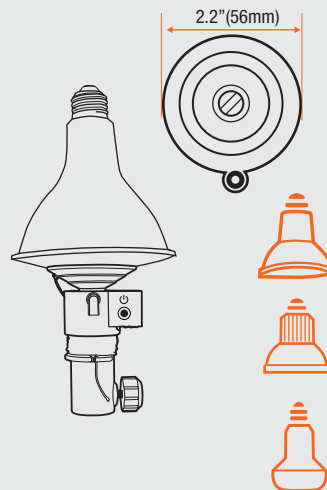

**NOTE:** Not recommended for round and non-smooth/textured surface bulbs

**Broken-bulb Extractors**

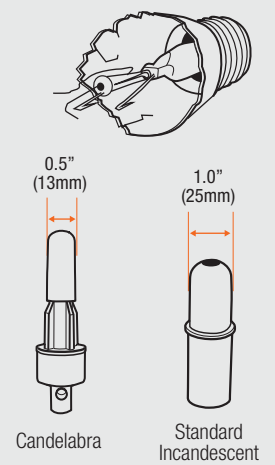

**CAUTION:** Turn off electricity before removing bulbs. Wear hand and eye protection when handling broken glass.

**Assembly Attaching Accessories**

**1** Position the accessory where **both holes align** to create a clear path.

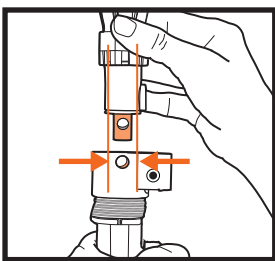

**2** While keeping the holes aligned, **insert accessory into the top** of the bulb changer.

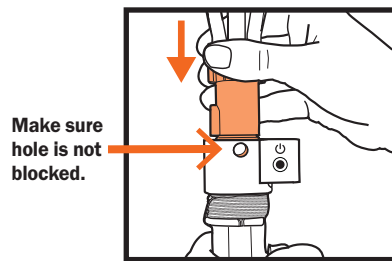

**3** **Insert locking pin** into the bulb changer (twist pin as you insert into hole).

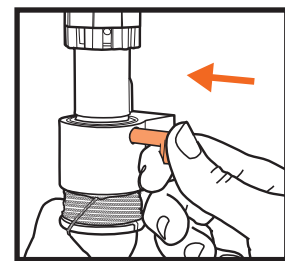

**STANDARD-SIZE spring-loaded cage for incandescent light bulbs:**

- Push cage on from the bottom onto standard light bulb.
- Turn to the left (counter-clockwise) to loosen and remove light bulb.

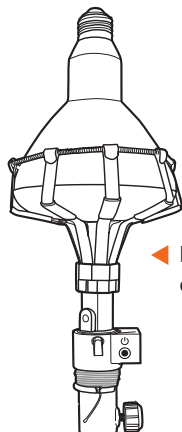

**LARGE-SIZE spring-loaded cage for flood light bulbs:**

- Slide attachment onto flood light bulb by pushing it over the bulb from the side.
- Turn to the left (counter-clockwise) to loosen and remove light bulb.

**LED Light**

To use LED light, **remove tab** to initiate battery.



## Assembly Attaching An Extension Pole\*

### Works with any 3/4" Standard Threaded Extension Pole

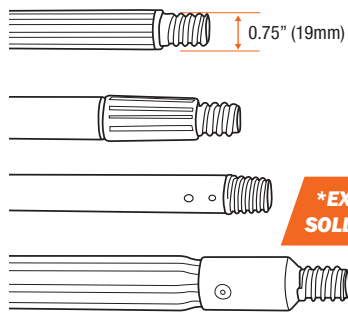

\*EXTENSION POLE SOLD SEPARATELY

Standard 3/4" Thread

- 1 Align an **extension pole** with a standard 3/4" thread (not included) to the bulb changer base.
- 2 Hand-tightening thumb-screw on base clock-wise direction.

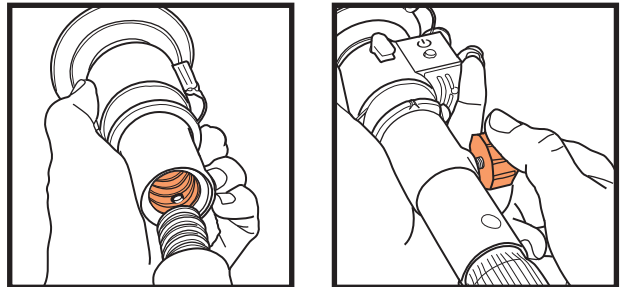

⚠ CAUTION: DO NOT USE PLIERS OR OVER TIGHTEN THE THUMB SCREW

## Instructions

- 1 Always shut off electrical power to the bulb you are changing! Allow time for bulb to cool.
- 2 Select the appropriate attachment and insert locking pin to secure (**Assembly Step #3**).
- 3 Screw onto the threaded end of an extension pole (not included). Hand tighten the thumb-screw on the EZ Smart bulb changer secure pole.
- 4 Press button to turn on LED light if needed.

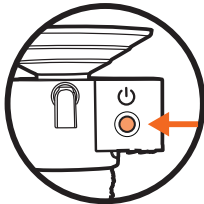

## Removing Attachments

- 1 Hold the bulb changer base securely in one hand while pressing firmly on one end of the locking pin. With your other hand pull the opposite end of locking pin.
- 2 Continue pulling until the pin is fully removed, allowing you to replace it with a different attachment.

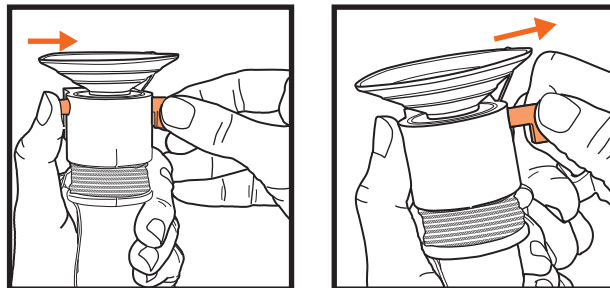

## Broken-bulb Removal

### Candelabra Extractor

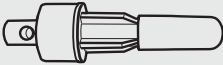

- 1 Align holes and insert into base
- 2 Insert locking pin

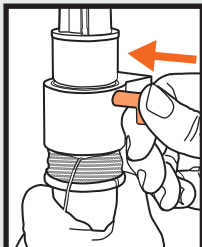
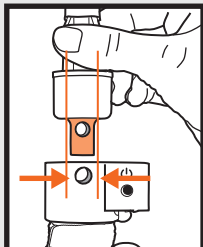

### Standard Bulb Extractor



- 3 Place bulb extractor over smaller extractor and push down firmly

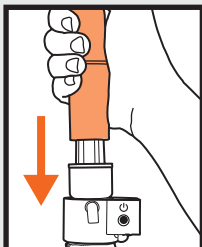
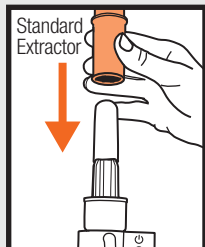

**INSTRUCTIONS:** Turn off electricity before changing bulbs. Wear hand and eye protection when handling broken glass.

- Choose 1/2" candelabra or standard 1" extractor to fit the bulb base.
- **To remove** broken bulb gently **push up and twist counter-clockwise**, increasing pressure as needed.

## Suction Cup Attachment

- 1 For bulb **REMOVAL** center suction cup on flat/smooth bulb and press gently to create suction.
- 2 Once secure, turn bulb changer counter-clockwise to unscrew.
- 3 Lower and remove bulb from suction cup pulling draw string to release suction.

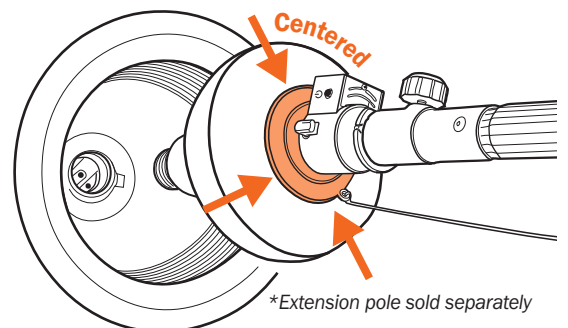
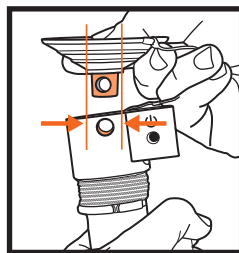

- 1 For **BULB REPLACEMENT**, center the suction cup on the new flat, smooth bulb and press gently to create suction.
- 2 **Using an Extension Pole (Optional):** Align the threads of an extension pole (not included) with the socket on the EZ Smart bulb changer. Turn the pole clockwise to secure it into place. Then, tighten the thumb screw on the EZ Smart bulb changer to ensure the pole is secure.
- 3 **Activating the LED Light:** Unwind the string and press the button on the LED light attachment to activate illumination.
- 4 **Bulb Installation:** Stand directly beneath the light bulb socket (not at an angle). Guide the new bulb into the recessed light housing. Turn the bulb changer clockwise (right) until the bulb is fully threaded into place.
- 5 **Releasing the Suction:** Pull the string to release the suction from the bulb, then carefully lower the EZ Smart bulb changer. Press the button on the bulb changer to turn off the LED light.

**TIP:** Bulbs that have been too tightly installed may require removal by hand. Using EZ Smart Bulb Changer for replacement will ensure easy operation in the future.

**WARNING:** This product can expose you to chemicals including Lead, which is known to the State of California to cause reproductive harm. For more information go to [www.P65Warnings.ca.gov](http://www.P65Warnings.ca.gov)



SCAN FOR MORE INFO

